

## 20 454 000 ATLANTA PILLAR TAP

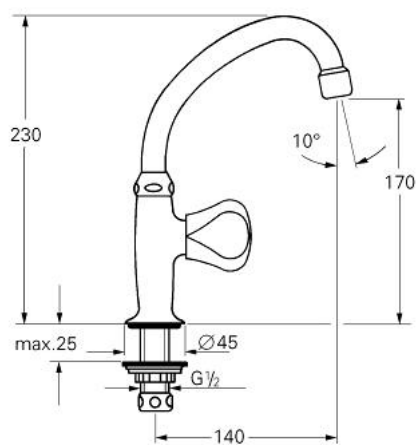

### PRODUCT DESCRIPTION

- Colour: chrome
- GROHE Long-Life headpart 1/2"
- Treflor-handle
- marking: blue/red
- swivelling spout
- mousseur
- union nut with 10.5 mm drilling
- GROHE Long-Life finish



## 20 454 000 ATLANTA PILLAR TAP

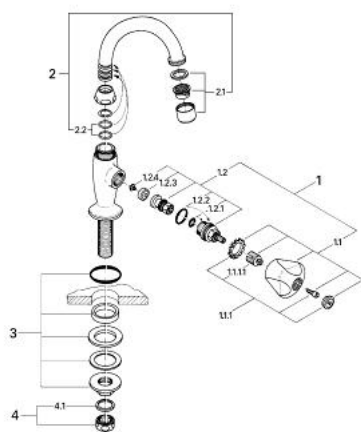

### SPARE PARTS, Januari 1981 – now

- 1: Headpart 1/2" (Spare part-nr. 11086000)
- 1.1: Treflor handle blue/red (Spare part-nr. 45124000)
- 1.1.1: Handle fixation (Spare part-nr. 45123000)
- 1.1.1.1: Repl. kit f.handle fastening (Spare part-nr. 0538600M)
- 1.2: Headpart 1/2" (Spare part-nr. 07146000)
- 1.2.1: O-ring  $\varnothing 6 \times \varnothing 2$  (Spare part-nr. 0128300M)
- 1.2.2: O-ring  $\varnothing 18.2 \times \varnothing 1.7$  (Spare part-nr. 0392400M)
- 1.2.3: Ball seal dia. 9x6.8 mm (Spare part-nr. 0529100M)
- 2: Swivel tube spout (Spare part-nr. 13071000)
- 2.1: Mousseur (Spare part-nr. 13928000)
- 2.1.1: Repl.kit f.Mousseur M22x1 and M24x1 (Spare part-nr. 45002000)
- 2.2: Repl.kit f.tube spout fasteninguntil '94 (Spare part-nr. 45006000)
- 2.2.1: Sealing washer (Spare part-nr. 0128500M)
- 2.2: Replacement kit for tube spout fastening from '95 (Spare part-nr. 45499000)
- 2.2.1: Sealing washer (Spare part-nr. 0128500M)
- 3: Shank fastening assembly (Spare part-nr. 45000000)
- 4: Coupling nut 1/2" x 10.5 mm (Spare part-nr. 1290100M)
- 4.1: Fibre seal dia. 12x2 mm (Spare part-nr. 0138900M)