

20 600 000 FLORIDA PILLAR TAP

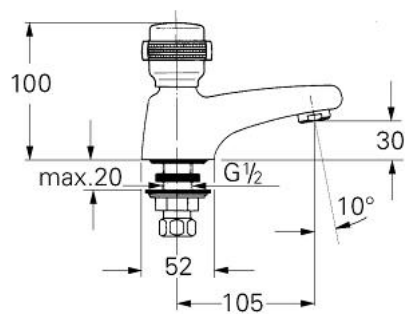

PRODUCT DESCRIPTION

- Colour: chrome
- ceramic headpart 1/2", 180°
- cast spout with Mousseur
- without handle
- union nut with 10.5 mm drilling
- GROHE Long-Life finish

20 600 000 FLORIDA PILLAR TAP

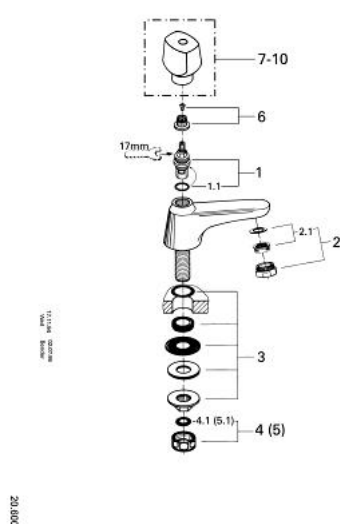

SPARE PARTS, Januari 1985 – now

- 1: Ceramic headpart, 1/2" (Spare part-nr. 45346000)
- 1.1: O-ring $\varnothing 18.2 \times \varnothing 1.7$ (Spare part-nr. 0392400M)
- 2: Mousseur (Spare part-nr. 13929000)
- 2.1: Repl.kit f.Mousseur M22x1 and M24x1 (Spare part-nr. 45002000)
- 3: Shank fastening assembly (Spare part-nr. 45000000)
- 4: Coupling nut 1/2" x 10.5 mm (Spare part-nr. 1290100M)
- 4.1: Fibre seal dia. 12x2 mm (Spare part-nr. 0138900M)
- 5: Coupling nut 1/2" x 14.5 mm (Spare part-nr. 1290200M)
- 5.1: Fibre seal dia. 12x2 mm (Spare part-nr. 0138900M)
- 6: Replacement handle connection kit (Spare part-nr. 45186000)
- 6.1: O-ring $\varnothing 18.2 \times \varnothing 1.7$ (Spare part-nr. 0392400M)
- 7: Handle (Spare part-nr. 45180000)*
- 8: Florida handle 115 (Spare part-nr. 45230000)*
- 9: Florida handle 500 (Spare part-nr. 45206000)*
- 10: Florida handle 510 (Spare part-nr. 45207000)*

* Optional accessories