

25 007 000 **SENTOSA BATH/SHOWER MIXER**

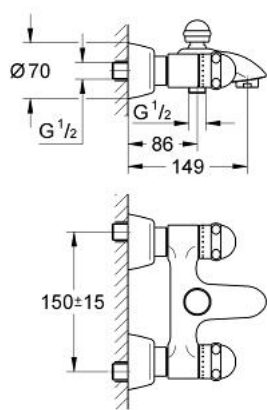

PRODUCT DESCRIPTION

- Colour: chrome
- wall mounted
- ceramic headparts 1/2", 180°
- automatic diverter: bath/shower
- mousseur
- shower outlet 1/2"
- integrated non-return valve
- S-unions
- GROHE Long-Life finish

25 007 000 SENTOSA BATH/SHOWER MIXER

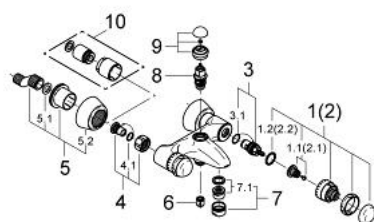

SPARE PARTS, Desember 2004 – now

- 1: Sentosa handle 1/2" (Spare part-nr. 45538IP0)
- 1.1: Replacement handle connection kit (Spare part-nr. 45186000)
- 1.1.1: O-ring $\varnothing 18.2 \times \varnothing 1.7$ (Spare part-nr. 0392400M)
- 1.2: Guide ring (Spare part-nr. 0202100M)
- 2: Sentosa handle 1/2" red (Spare part-nr. 45539IP0)
- 2.1: Replacement handle connection kit (Spare part-nr. 45186000)
- 2.2: Guide ring (Spare part-nr. 0202100M)
- 3: Ceramic headpart, 1/2" (Spare part-nr. 45346000)
- 3.1: O-ring $\varnothing 18.2 \times \varnothing 1.7$ (Spare part-nr. 0392400M)
- 4: Screw joint (Spare part-nr. 45544000)
- 4.1: Seal dia. 15x2 mm (Spare part-nr. 0311900M)
- 5: S-union (Spare part-nr. 12058000)
- 5.1: Ball seal dia. 9x6.8 mm (Spare part-nr. 0138600M)
- 5.2: Covering escutcheon (Spare part-nr. 45545000)
- 6: Non-return valve (Spare part-nr. 08565000)
- 7: Mousseur (Spare part-nr. 13927000)
- 7.1: Repl.kit f.aerator M28x1 (Spare part-nr. 45029000)
- 8: Diverter (Spare part-nr. 08915000)
- 9: Diverter knob (Spare part-nr. 45547IP0)
- 10: Extension set 1/2", 30 mm (Spare part-nr. 46238000)*

* Optional accessories