

25 085 000 AVINA BATH/SHOWER MIXER

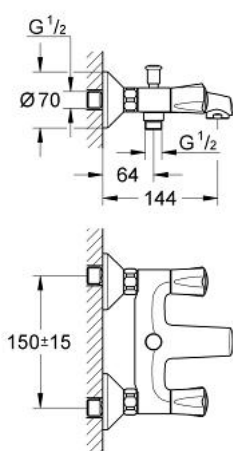

PRODUCT DESCRIPTION

- Colour: chrome
- wall mounted
- metal handles
- heat-insulated
- screwable
- Carbodur headpart
- automatic diverter: bath/shower
- mousseur
- S-unions
- GROHE Long-Life finish

25 085 000 AVINA BATH/SHOWER MIXER

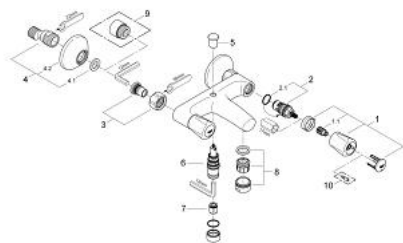

SPARE PARTS, Juni 2007 – now

- 1: handle Atlanta (Spare part-nr. 45993000)
 - 1.1: Repl. kit f.handle fastening (Spare part-nr. 0538600M)
 - 2: Ceramic headpart, 1/2" (Spare part-nr. 45346000)
 - 2.1: O-ring $\varnothing 18.2 \times \varnothing 1.7$ (Spare part-nr. 0392400M)
 - 3: Screw joint (Spare part-nr. 45544000)
 - 4: S-union (Spare part-nr. 12075000)
 - 4.1: Ball seal dia. 9x6.8 mm (Spare part-nr. 0138600M)
 - 4.2: Escutcheon (Spare part-nr. 0221000M)
 - 5: Diverter knob (Spare part-nr. 65648000)
 - 6: Diverter (Spare part-nr. 65655000)
 - 7: Non-return valve (Spare part-nr. 08565000)
 - 8: Mousseur (Spare part-nr. 13927000)
 - 9: Extension 3/4", 20 mm (Spare part-nr. 0713000M)*
 - 10: Screw for Costa/Avina products (Spare part-nr. 48013000)*
- * Optional accessories