

25 344 000 ATLANTA BATH/SHOWER MIXER

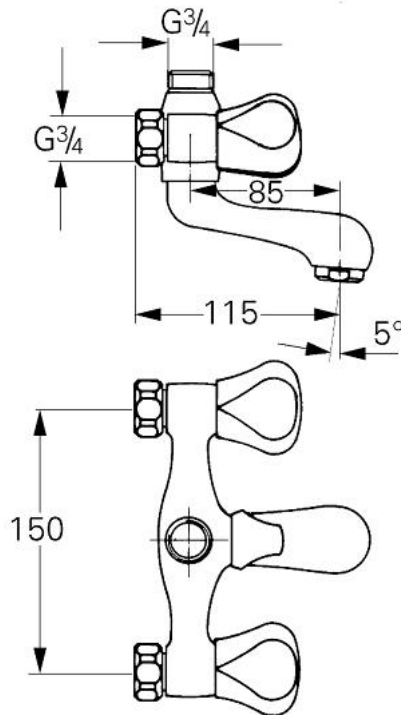

PRODUCT DESCRIPTION

- Colour: chrome
- wall mounted
- Teflon-handles
- automatic diverter: bath/shower
- mousseur
- shower connection 1/2"
- without connection unions
- GROHE Long-Life finish



25 344 000 ATLANTA BATH/SHOWER MIXER

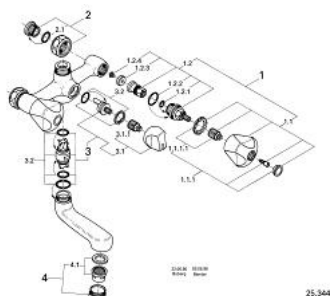

SPARE PARTS, Januari 1981 – now

- 1: Headpart 1/2" (Spare part-nr. 11086000)
- 1.1: Treflor handle blue/red (Spare part-nr. 45124000)
- 1.1.1: Handle fixation (Spare part-nr. 45123000)
- 1.1.1.1: Repl. kit f.handle fastening (Spare part-nr. 0538600M)
- 1.2: Headpart 1/2" (Spare part-nr. 07146000)
- 1.2.1: O-ring $\varnothing 6 \times \varnothing 2$ (Spare part-nr. 0128300M)
- 1.2.2: O-ring $\varnothing 18.2 \times \varnothing 1.7$ (Spare part-nr. 0392400M)
- 1.2.3: Ball seal dia. 9x6.8 mm (Spare part-nr. 0529100M)
- 2: Screw joint (Spare part-nr. 45044000)
- 2.1: Seal dia. 15x2 mm (Spare part-nr. 0311900M)
- 3: Diverter (Spare part-nr. 45128000)
- 3.1: Repl. kit f.handle fastening (Spare part-nr. 0538600M)
- 4: Mousseur (Spare part-nr. 13927000)
- 4.1: Repl.kit f.aerator M28x1 (Spare part-nr. 45029000)