

## 25 426 000 ATLANTA BATH/SHOWER MIXER



### PRODUCT DESCRIPTION

- Colour: chrome
- wall mounted
- Treflor-handles
- ceramic headparts 1/2", 180°
- automatic diverter: bath/shower
- mousseur
- shower connection 1/2"
- without connection unions
- GROHE Long-Life finish

## 25 426 000 ATLANTA BATH/SHOWER MIXER

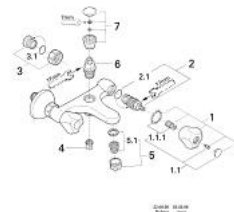

25-426

### SPARE PARTS, Januari 1988 – now

- 1: Treflor handle blue/red (Spare part-nr. 45124000)
- 1.1: Handle fixation (Spare part-nr. 45123000)
- 1.1.1: Repl. kit f.handle fastening (Spare part-nr. 0538600M)
- 2: Ceramic headpart, 1/2" (Spare part-nr. 45346000)
- 2.1: O-ring  $\varnothing 18.2 \times \varnothing 1.7$  (Spare part-nr. 0392400M)
- 3: Screw joint (Spare part-nr. 45044000)
- 3.1: Seal dia. 15x2 mm (Spare part-nr. 0311900M)
- 4: Non-return valve (Spare part-nr. 08565000)
- 5: Mousseur (Spare part-nr. 13927000)
- 5.1: Repl.kit f.aerator M28x1 (Spare part-nr. 45029000)
- 6: Diverter (Spare part-nr. 08915000)
- 7: Diverter knob (Spare part-nr. 07526000)