

## 27 004 000 FREEHANDER SHOWER SYSTEM

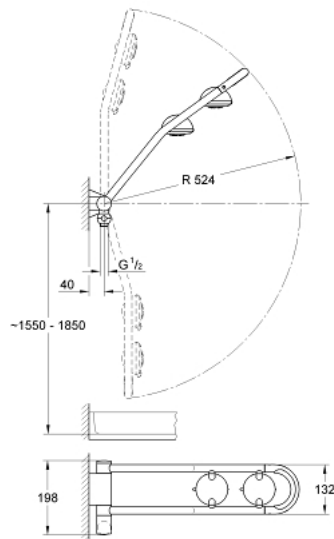

### PRODUCT DESCRIPTION

- Colour: chrome
- with two rotating shower heads
- swivelling for using as head- and side shower
- 1 shower head with wide, Pulsator and Eco spray
- 1 shower head with wide and pulsator spray
- lockable
- both heads with speed clean anti lime-scale system
- self stopping joint
- Grohcklick-elements for shower hoses and handshower
- GROHE Long-Life finish
- not suitable for instantaneous heater
- minimum pressure 1,0 bar



## 27 004 000 FREEHANDER SHOWER SYSTEM

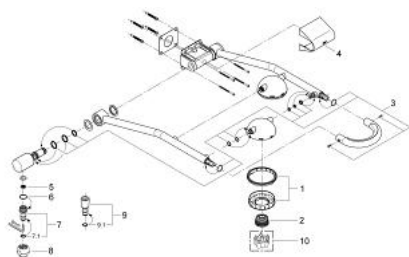

### SPARE PARTS, Juni 2007 – now

- 1: Spray faceplate (Spare part-nr. 45877P00)
  - 2: Replacement pulsator element (Spare part-nr. 45656XX0)
  - 3: Repl. kit f. seal (Spare part-nr. 45878000)
  - 4: Cap (Spare part-nr. 45879000)
  - 5: Dirt strainer (Spare part-nr. 0700200M)
  - 6: O-ring  $\varnothing 18.2 \times \varnothing 1.7$  (Spare part-nr. 0392400M)
  - 7: Coupling piece (Spare part-nr. 28635XX0)
  - 7.1: O-ring  $\varnothing 11 \times \varnothing 2$  (Spare part-nr. 0122400M)
  - 8: Snap coupling (Spare part-nr. 45899000)
  - 9: Outlet nipple (Spare part-nr. 45900000)
  - 9.1: O-ring  $\varnothing 11 \times \varnothing 2$  (Spare part-nr. 0122400M)
  - 10: Disassembling key
- (for Relexa Plus, Relexa Cosmopolitan face plate) (Spare part-nr. 45654000)\*
- \* Optional accessories