

27 433 000 RAINSHOWER ICON SYSTEM 190 SHOWER SYSTEM

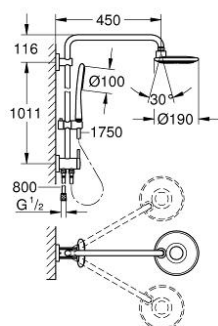

PRODUCT DESCRIPTION

- Colour: chrome
- consists of:
 - Horizontal swivable 450 mm shower arm
 - change between hand and head shower by diverter
 - head shower Icon (27 439 000)
 - chrome plated spray plate
 - with ball joint
 - angle of rotation $\pm 15^\circ$
 - Handshower Icon 27 276 000
 - adjustable in height with gliding element (12 140 000)
 - 9,5 l/min. flow limiter
 - connection to water supply with 1/2"-thread of the 800 mm shower hose to faucet / wall union
 - shower hose Silverflex 1750 mm 1/2" x 1/2" (28 388)
 - minimum flow rate 7 l/min.
 - GROHE Water Saving - Less water, perfect flow
 - GROHE DreamSpray perfect spray pattern
 - GROHE Long-Life finish
 - SpeedClean anti-lime system
 - suitable for instantaneous heaters (min. 19 kW/h)



27 433 000 RAINSHOWER ICON SYSTEM 190 SHOWER SYSTEM

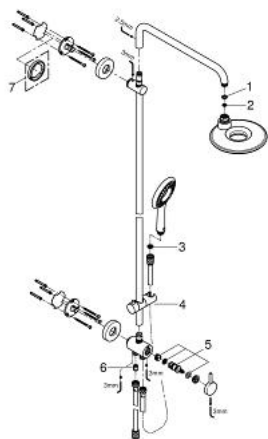

SPARE PARTS, November 2009 – now

- 1: Fibre seal dia. 12x2 mm (Spare part-nr. 0138900M)
- 2: Dirt strainer (Spare part-nr. 48007000)
- 3: Dirt strainer (Spare part-nr. 0700200M)
- 4: Sliding piece (Spare part-nr. 12140000)
- 5: Repl.kit f.rotary valve (Spare part-nr. 45915000)
- 6: Non-return valve (Spare part-nr. 08565000)
- 7: Compensation disc (Spare part-nr. 27180000)*

* Optional accessories