

## 33 831 000 EURODISC SPECIAL SINGLE-LEVER MIXER 1/2"

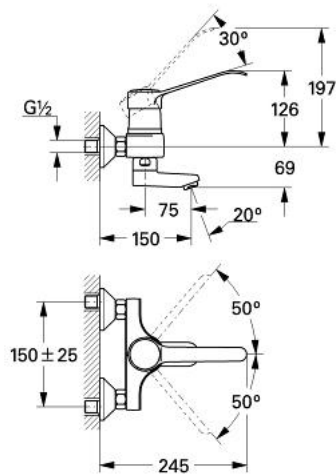

### PRODUCT DESCRIPTION

- Colour: chrome
- for hospital basin
- wall mounted
- GROHE SilkMove 46 mm ceramic cartridge
- flow straightener with flow limiter
- metal lever head with chrome plated cover plates
- lever length 170 mm
- temperature limiter
- cast swivel spout, lockable
- projection 152 mm
- S-unions
- GROHE Long-Life finish

## 33 831 000 EURODISC SPECIAL SINGLE-LEVER MIXER 1/2"

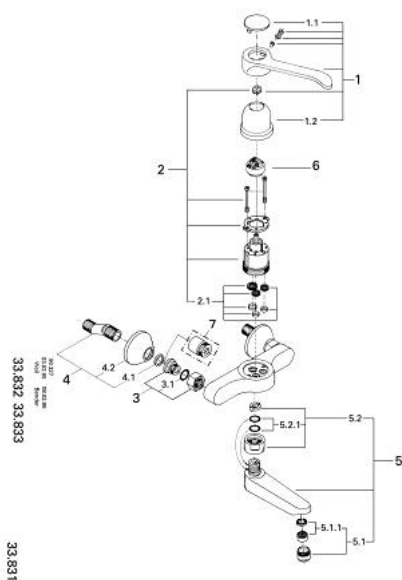

### SPARE PARTS, Januari 1992 – now

- 1: Lever, length 170mm (Spare part-nr. 46093000)
  - 1.1: Cap (Spare part-nr. 46081000)
  - 1.2: Shield (Spare part-nr. 01734000)
  - 2: Cartridge (Spare part-nr. 46048000)
  - 2.1: Repl. kit f. seal (Spare part-nr. 46209000)
  - 3: Screw joint (Spare part-nr. 45044000)
  - 3.1: Seal dia. 15x2 mm (Spare part-nr. 0311900M)
  - 4: S-union (Spare part-nr. 12075000)
  - 4.1: Ball seal dia. 9x6.8 mm (Spare part-nr. 0138600M)
  - 4.2: Escutcheon (Spare part-nr. 0221000M)
  - 5: Cast swivel spout (Spare part-nr. 13460000)
  - 5.1: Flow straightener (Spare part-nr. 13960000)
  - 5.1.1: Filter, Mousseur (Spare part-nr. 45479000)
  - 5.2: Repl. kit f. cast spout (Spare part-nr. 46082000)
  - 5.2.1: Sealing washer (Spare part-nr. 0128500M)
  - 6: Temperature limiter (when 46 048 until '96) (Spare part-nr. 46153000)
  - 6: Temperature limiter (Spare part-nr. 46308000)
  - 7: Extension 3/4", 20 mm (Spare part-nr. 0713000M)\*
- \* Optional accessories