

33 863 UL0 EUROPLUS SINGLE-LEVER SINK MIXER 1/2"

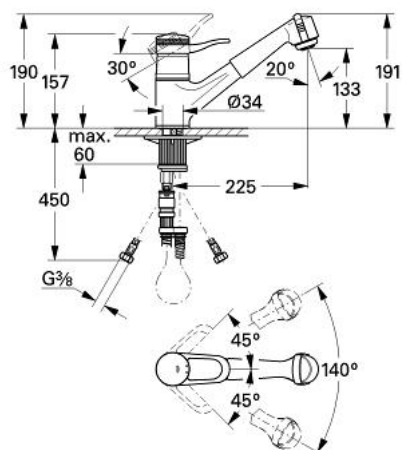

PRODUCT DESCRIPTION

- single hole installation
- GROHE SilkMove 46 mm ceramic cartridge
- swivelling cast spout with stop limiter
- integrated pull out shower
- automatic returning
- automatic diverter:
- Mousseur/shower spray
- flexible connection hoses
- rapid-installation-system
- optional temperature limiter ref. no. 46 308
- GROHE Long-Life finish

33 863 UL0 EUROPLUS SINGLE-LEVER SINK MIXER 1/2"



SPARE PARTS, Januari 1987 – now

- 1: Lever (Spare part-nr. 46129UL0)
- 1.1: Cap (Spare part-nr. 46130UL0)
- 2: Cartridge (Spare part-nr. 46048000)
- 2.1: Repl. kit f. seal (Spare part-nr. 46209000)
- 3: Shield (Spare part-nr. 01734UL0)
- 4: Hand shower (Spare part-nr. 46252UL0)
- 4.1: Repl. kit f. Mousseur M22x1 and M24x1 (Spare part-nr. 45002000)
- 4.2: Non-return valve (Spare part-nr. 08565000)
- 5: Metal hose (Spare part-nr. 46092000)
- 6: Shank mounting kit (Spare part-nr. 46346000)
- 6.1: Temperature limiter (Spare part-nr. 04174000)
- 7: Compression spring (Spare part-nr. 07240000)
- 8: Temperature limiter (when 46 048 until '96) (Spare part-nr. 46153000)*
- 8: Temperature limiter (Spare part-nr. 46308000)*
- 9: Connection hose (Spare part-nr. 45120000)*

* Optional accessories