

39 972 000 **NOVA COSMOPOLITAN LIGHT FLUSH PLATE**

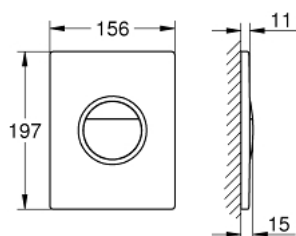

PRODUCT DESCRIPTION

- Colour: chrome
- for dual flush or start & stop actuation
- external highlighted outline
- with LEDs in blue, red, yellow, green
- colour gradient adjustable
- on/off button
- timer for individual regulation of illuminating period
- 3 m connecting cable
- transformer for external installation
- operating voltage 230 V AC
- 50/60 Hz, 2.0 VA
- CE approved
- for pneumatic discharge valve AV1
- vertical and horizontal installation
- 156 x 197 mm
- material: ABS
- GROHE Long-Life finish
- GROHE Water Saving - Less water, perfect flow
- for combination with Rapid SL and Uniset with GD 2 cistern
- for use with Rapid SLX please order shaft 66 791 000 (sold separately)

39 972 000 **NOVA COSMOPOLITAN LIGHT FLUSH PLATE**

SPARE PARTS, Oktober 2021 – now

1: Frame (Spare part-nr. 42358000)

1.1: Screw dia. 4x52 mm (Spare part-nr. 6636200M)

2: Switching power supply (Spare part-nr. 66960000)

3: Top plate with electronic (Spare part-nr. 42359000)

4: Push button (Spare part-nr. 48614000)

5: Extension cable (Spare part-nr. 36221000)

6: Extension cable (Spare part-nr. 36222000)*

* Optional accessories

